



# CYCLONE LEVEL SYSTEM

FASTER PERFECT LEVELING

[www.rubi.com](http://www.rubi.com)

# CYCLONE LEVEL SYSTEM

## FASTER PERFECT LEVELING



**1** A tool is not required for their installation.  
Recommended for tiles with thicknesses from 3 to 20 mm.

**2** EASY, QUICK and INTUITIVE to USE.

**3** LARGE and ERGONOMIC Cap.  
Does not injure fingers when tightening. Reusable caps.

**4** System removal by IMPACT (kick or mallet).  
ALWAYS in the direction of the grout joint.

**5** The base of the clip ensures continuous tension between the clip and the cap.

### CYCLONE FLAT BASE



	REF		
CYCLONE L.S. 1 MM FLAT BASE (B-100)	35937	36	-
CYCLONE L.S. 1 MM FLAT BASE (B-300)	35938	12	-
CYCLONE L.S. 1 MM FLAT BASE (B-2400)	35939	1	-
CYCLONE L.S. 1,5 MM FLAT BASE (B-100)	35940	36	-
CYCLONE L.S. 1,5 MM FLAT BASE (B-300)	35941	12	-
CYCLONE L.S. 1,5 MM FLAT BASE (B-2400)	35942	1	-
CYCLONE L.S. 2 MM FLAT BASE (B-100)	35943	36	-
CYCLONE L.S. 2 MM FLAT BASE (B-300)	35944	12	-
CYCLONE L.S. 2 MM FLAT BASE (C-2400)	35945	1	-
CYCLONE L.S. 3 MM FLAT BASE (B-100)	35946	36	-
CYCLONE L.S. 3 MM FLAT BASE (B-300)	35947	12	-
CYCLONE L.S. 3 MM FLAT BASE (C-2400)	35948	1	-

### CYCLONE CROSS BASE



	REF		
CYCLONE L.S. 1,5 MM CROSS BASE (B-100)	35952	36	-
CYCLONE L.S. 1,5 MM CROSS BASE (B-300)	35953	12	-
CYCLONE L.S. 1,5 MM CROSS BASE (B-2400)	35954	1	-
CYCLONE L.S. 3 MM CROSS BASE (B-100)	35955	36	-
CYCLONE L.S. 3 MM CROSS BASE (B-300)	35956	12	-
CYCLONE L.S. 3 MM CROSS BASE (B-2400)	35957	1	-
T-STRIP 1,5 MM CYCLONE LS (B-100)	35958	36	-
T-STRIP 1,5 MM CYCLONE LS (B-300)	35959	12	-
T-STRIP 1,5 MM CYCLONE LS (C-2400)	35960	1	-
T-STRIP 3 MM CYCLONE LS (B-100)	35961	36	-
T-STRIP 3 MM CYCLONE LS (B-300)	35962	12	-
T-STRIP 3 MM CYCLONE LS (C-2400)	35963	1	-

### CYCLONE CAPS



	REF		
CYCLONE CAPS (B-100)	35949	5	-
CYCLONE CAPS (B-300)	35950	4	-
CYCLONE CAPS (B-1200)	35951	1	-



#### STEP BY STEP

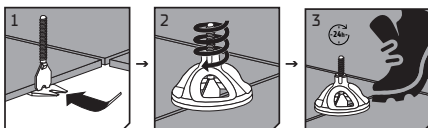

**RUBI UK LTD.**  
Units 16 & 17, Easter Park,  
Ferry Lane  
Rainham, Essex  
RM13 9BP - UNITED KINGDOM  
P. 44 (O) 1708559609  
F. 44 (O) 1708553813  
rubiuk@rubi.com



1 84 13797 92802 9



Ref. 92802